

**2,100 S.F. / Northwest Area**  
**21211 FM 529 - (Suite 107) - Cypress, TX 77433**



**Property Description:**

**OFFICE SPACE 2,100 SF / MULTI-TENANT / BUILD-TO-SUIT /  
17'-9" EAVE HEIGHT / LOCATED OFF US HIGHWAY 99**

**Key Features:**

- **TOTAL BLDG: 13,850 SF**
- **BUILD-TO-SUIT**
- **EAVE HEIGHT: 17'-9"**
- **TILT WALL BLDG**
- **EASY ACCESS TO US HIGHWAY 99**



**FOUR SEASONS DEVELOPMENT CO., INC.**  
**FOUR SEASONS BUSINESS PARK**

**5825 W Sam Houston Pkwy N**  
**Houston, TX 77041**

**P: 713-466-7077**

**F: 713-896-4775**

**[www.fourseasonsdevelopmentco.com](http://www.fourseasonsdevelopmentco.com)**

**2,100 S.F. / Northwest Area**  
**21211 FM 529 - (Suite 107) - Cypress, TX 77433**

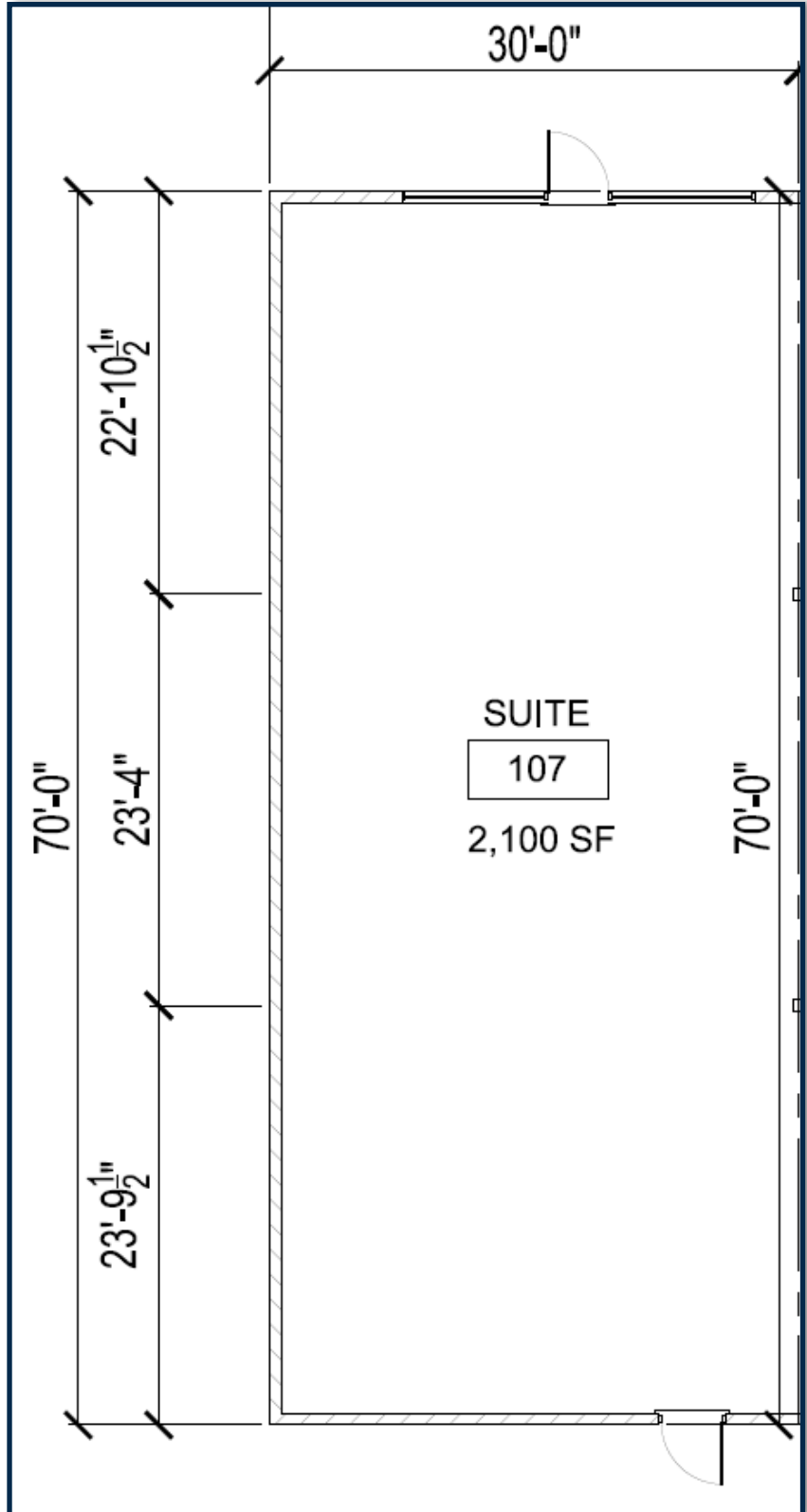

\*NO WARRANTY OR REPRESENTATION, EXPRESSED OR IMPLIED, IS MADE AS TO THE ACCURACY OF THE INFORMATION CONTAINED HEREIN AND SAME IS SUBMITTED SUBJECT TO ERRORS, OMMISIONS, CHANGE OF PRICES, RENTAL OR OTHER CONDITIONS.