

**4,235 S.F. / Beltway 8 Frontage/ Northwest Houston**  
**5829 W. Sam Houston Pkwy N. (Suite 106) - Houston, TX 77041**

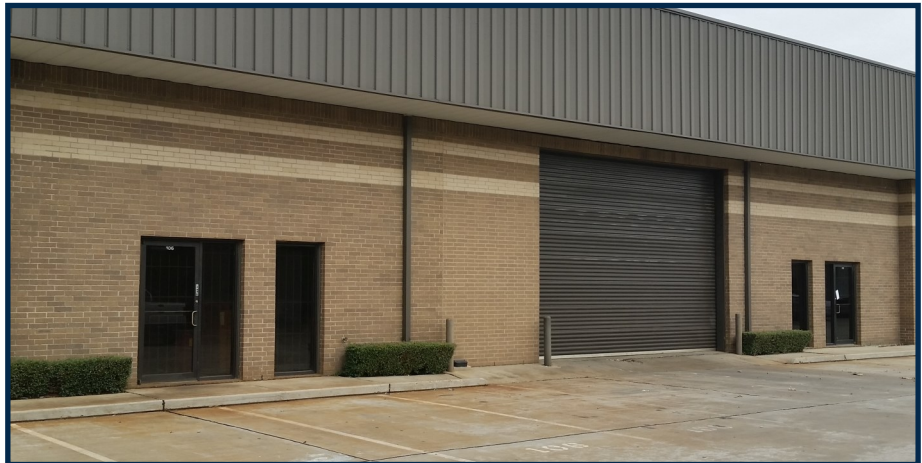
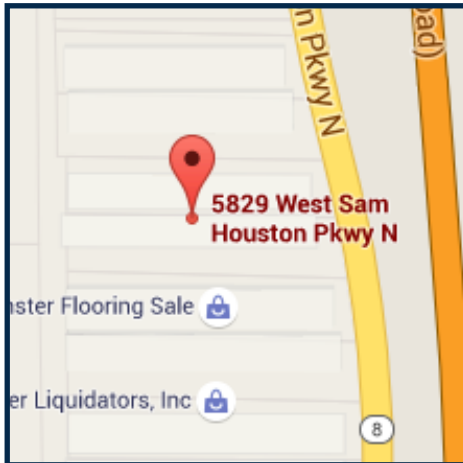

**Property Description:**

**4,235 SF / BUILD-TO-SUIT/ MULTI-TENANT/ 18' EAVE HEIGHT**  
**3 PHASE 480V ELECTRICAL / (1) 20'X18' GRADE LEVEL ROLL-UP DOORS**  
**LOCATED ON BELTWAY 8 IN NORTHWEST HOUSTON**

**Key Features:**

- **TOTAL BLDG: 4,235 SF**
- **BUILD-TO-SUIT**
- **EAVE HEIGHT: 18'**
- **ELECTRICAL: 3 PHASE 480V**
- **(1) 20'X18' GRADE LEVEL ROLL-UP DOORS**
- **BELTWAY 8 FRONTAGE**



**FOUR SEASONS DEVELOPMENT CO., INC.**  
**FOUR SEASONS BUSINESS PARK**

**5825 W Sam Houston Pkwy N**  
**Houston, TX 77041**

**P: 713-466-7077**

**F: 713-896-4775**

**[www.fourseasonsdevelopmentco.com](http://www.fourseasonsdevelopmentco.com)**

**4,235 S.F. / Beltway 8 Frontage/ Northwest Houston**  
**5829 W. Sam Houston Pkwy N. (Suite 106) - Houston, TX 77041**

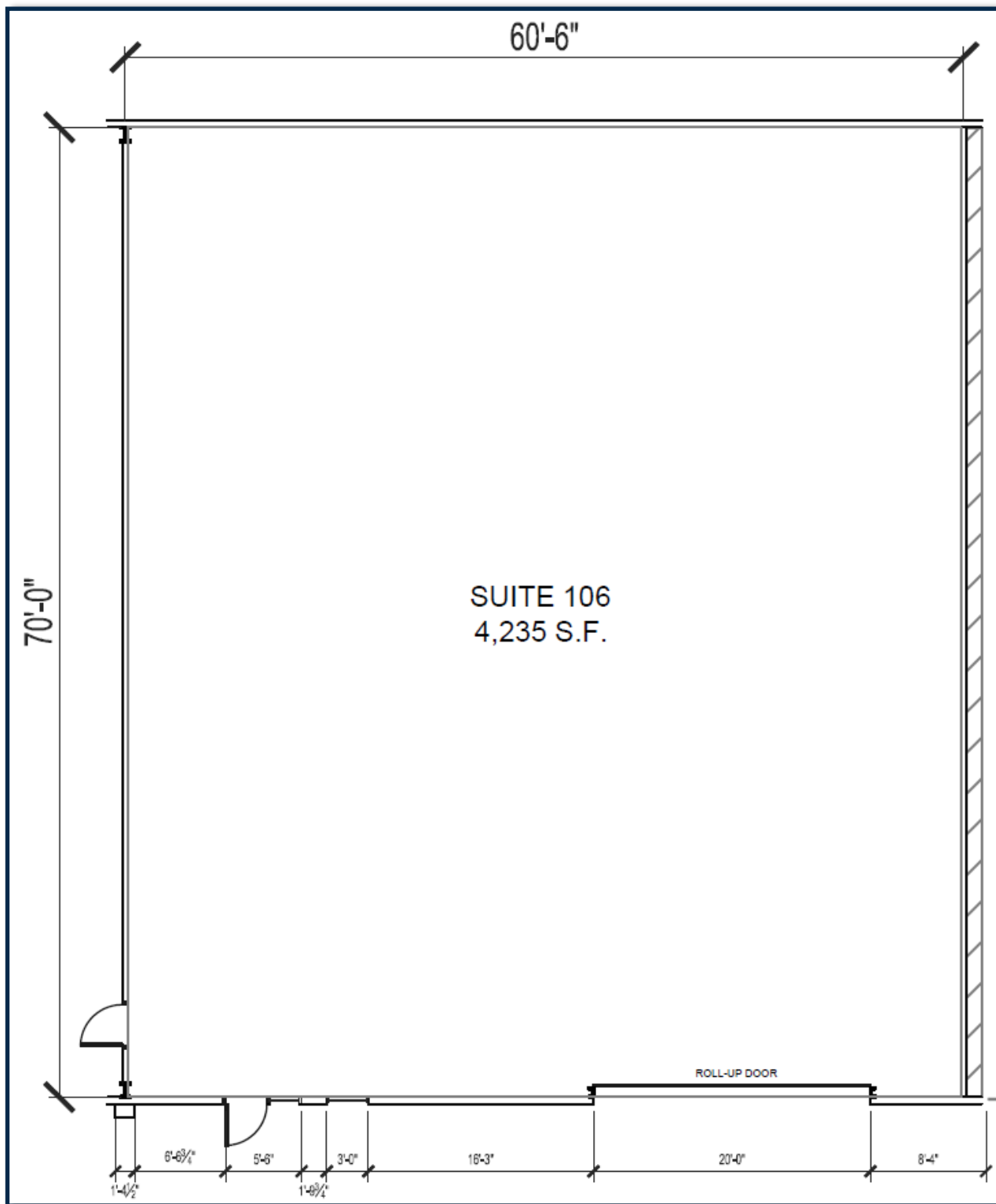

\*NO WARRANTY OR REPRESENTATION, EXPRESSED OR IMPLIED, IS MADE AS TO THE ACCURACY OF THE INFORMATION CONTAINED HEREIN AND SAME IS SUBMITTED SUBJECT TO ERRORS, OMMISIONS, CHANGE OF PRICES, RENTAL OR OTHER CONDITIONS.