

**24,800 S.F. / 10 Ton & 5 Ton Crane Served/ Northwest Houston  
6303 N. Sam Houston Pkwy W. - Houston, TX 77086**

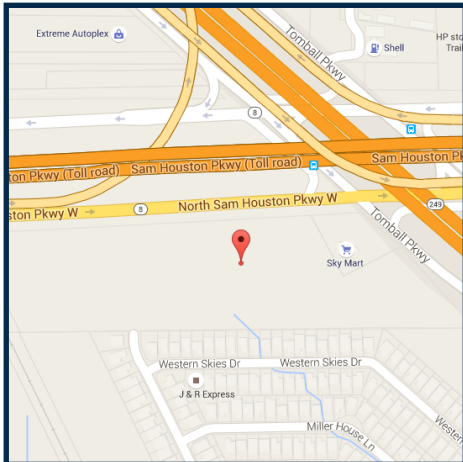

**Property Description:**

**24,800 SF/ 6,473SF 1ST & 2ND FLOOR/ 10 & 5 TON CRANE SERVED/ 28' EAVE HEIGHT/ 1.9 ACRES OF LAND/  
(1) 14'X16' & (4) 16'X16' GRADE LEVEL ROLL-UP DOORS  
LOCATED BETWEEN BELTWAY 8 AND HWY 249**

**Key Features:**

- **TOTAL BLDG: 24,800 SF**
- **1ST FLOOR OFFICE - 6,473SF, 2ND FLOOR OFFICE - 6,473SF**
- **10 & 5 TON CRANE SERVED**
- **EAVE HEIGHT: 28'**
- **AMPLE YARD/OUTSIDE STORAGE SPACE**
- **(1) 14X16' GRADE LEVEL ROLL-UP DOOR**
- **(4) 16X16' GRADE LEVEL ROLL-UP DOORS**
- **EASY ACCESS TO BELTWAY 8 AND HWY 249**



**FOUR SEASONS DEVELOPMENT CO., INC.  
FOUR SEASONS BUSINESS PARK**

**5825 W Sam Houston Pkwy N  
Houston, TX 77041**

**P: 713-466-7077  
F: 713-896-4775**

**[www.fourseasonsdevelopmentco.com](http://www.fourseasonsdevelopmentco.com)**

# 24,800 S.F. / 10 Ton & 5 Ton Crane Served/ Northwest Houston 6303 N. Sam Houston Pkwy W. - Houston, TX 77086

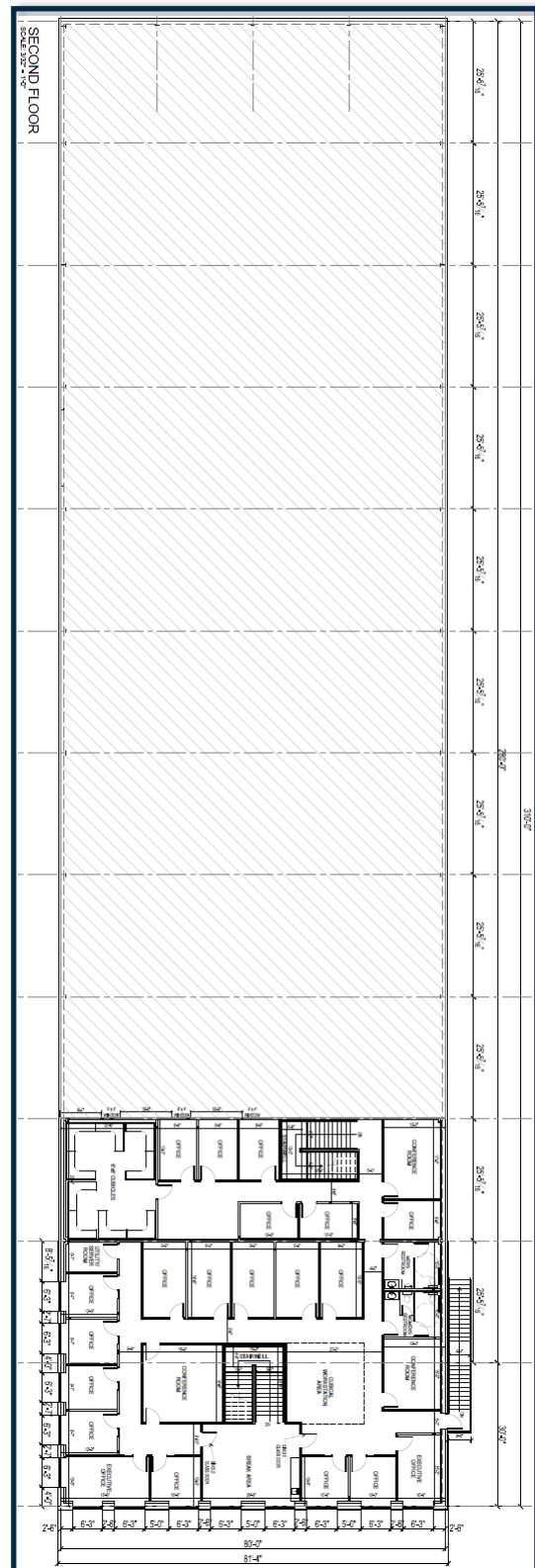
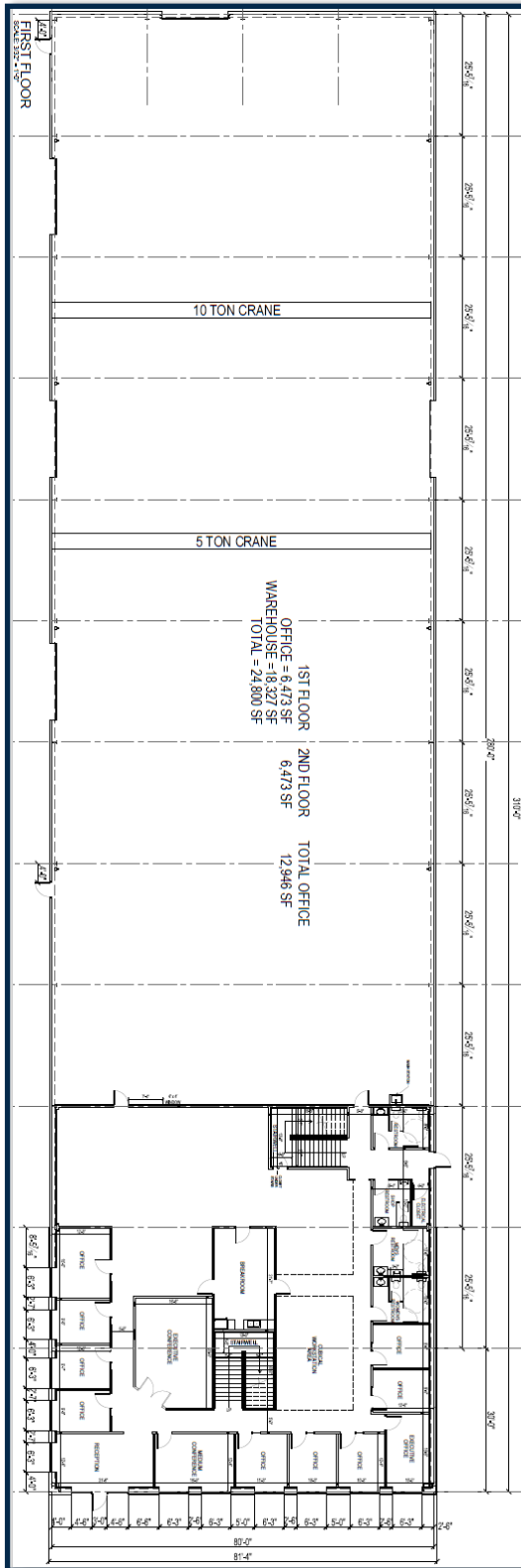

**\*NO WARRANTY OR REPRESENTATION, EXPRESSED OR IMPLIED, IS MADE AS TO THE ACCURACY OF THE INFORMATION CONTAINED HEREIN AND SAME IS SUBMITTED SUBJECT TO ERRORS, OMISSIONS, CHANGE OF PRICES, RENTAL OR OTHER CONDITIONS.**